



BRUMMER ELEMENTARY:

- BACK-UP GENERATOR

SALEM ELEMENTARY:

- BACK-UP GENERATOR
- WELL UPGRADE

SAYRE ELEMENTARY:

- (4) BOILER REPLACEMENTS

ELEMENTARY & MIDDLE SCHOOLS



CENTENNIAL MIDDLE SCHOOL:

- BRICK TUCKPOINTING
- REPLACE MECHANICAL ROOFTOP UNITS ON GYMNASIUM, CAFETERIA & ORIGINAL PORTION OF THE SCHOOL

MILLENNIUM MIDDLE SCHOOL:

- BRICK TUCKPOINTING
- REPLACE ELEVATOR
- REPLACE BOILER & RELATED PUMPS

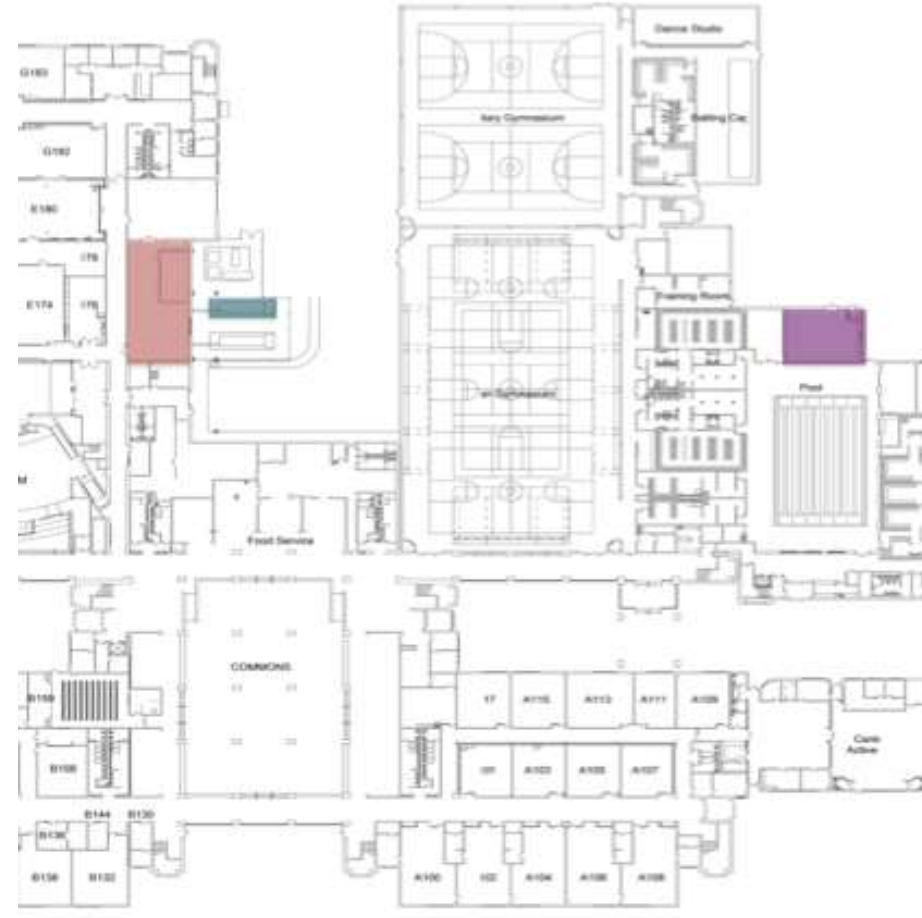
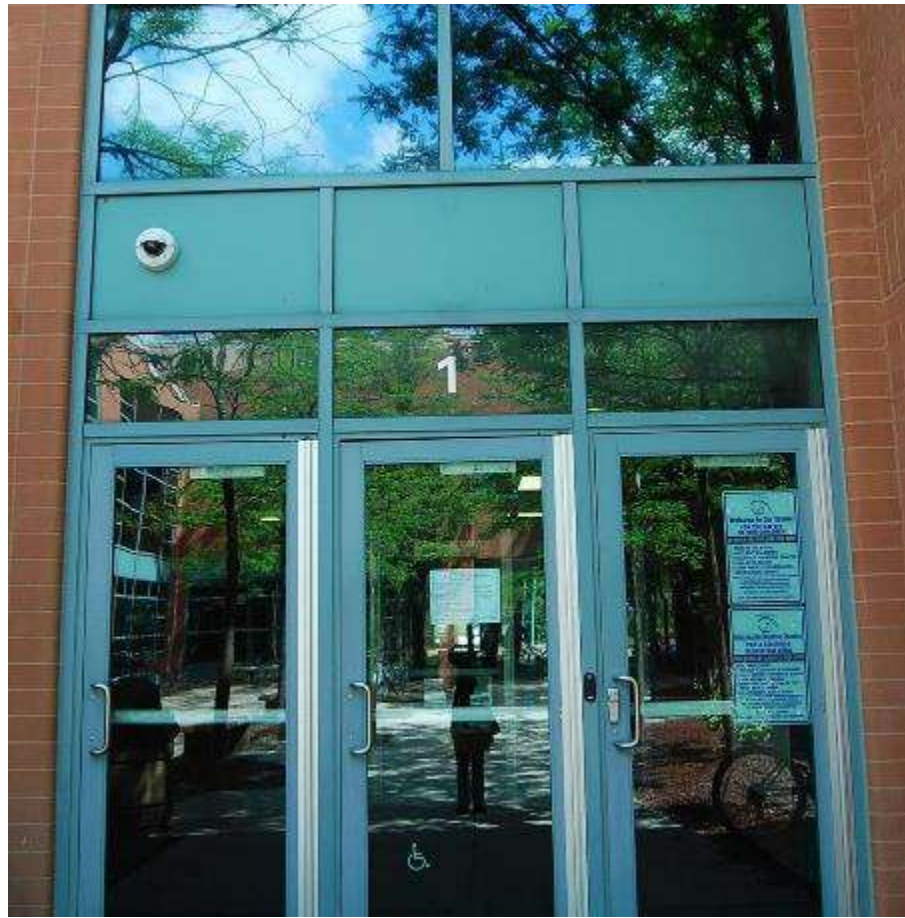

- REPLACE MAIN GYM DOORS
- REPLACE STOREFRONT ENTRY DOORS AT THEATER & GYM
- REPLACE EXTERIOR DOORS
- REPLACE EXTERIOR DOORS AT COMMONS HALL
- BRICK TUCKPOINTING

- REPLACE (3) BOILERS & PUMPS
- REPLACE CHILLER
- REPLACE DOMESTIC HOT WATER & POOL WATER HEATER

- CORRIDOR CARPET & BASE REPLACEMENT (SECOND LEVEL)



- RE-MARCITE POOL TANK
- RENOVATE AUXILIARY GYMNASIUM
 - RESTORE GYM FLOOR
 - RECONFIGURE AUXILIARY GYM BLEACHERS
- RENOVATE MAIN GYMNASIUM
 - RESTORE GYM FLOOR
 - REPLACE MAIN GYM SCOREBOARD

SOUTH LYON HIGH SCHOOL INFRASTRUCTURE IMPROVEMENTS